

***HYDRULIC MOTORS AVAILABLE:**

PART NUMBER	DISPLACEMENT	RATED PSI
4200SA - 16	.95 cu. in.	3,500
4200SA - 15	.88 cu. in.	3,500
4200SA/5000 - 16	.63 cu. in.	5,000
4200SA/5000 - 15	.59 cu. in.	5,000

INERSPACE CORP.
 1138 E. EDNA PLACE
 COVINA, CA 91724
 TEL: (626) 331-0921
 FAX: (626) 966-6391
 www.innerspacethrusters.com

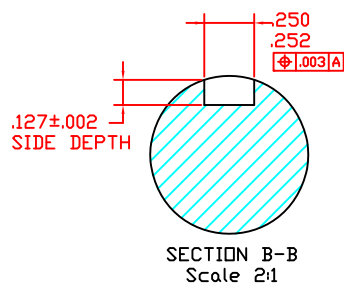

MOUNTING THREAD PATTERN
 3/8 - 24 UNF-2B THRU
 4 PLS DN Ø4.560 BC

TOLERANCES (EXCEPT AS NOTED)		REVISIONS			INERSPACE CORP.				
		NO.	DATE	BY	OUTSIDE PROFILE OF 4200SA MOTOR				
.XXX	± .005	1							
.XX	± .01	2							
ANGULAR	°	3			DRAWN BY	OR	SCALE	FULL	MATERIAL
± 1/2		4			CHECKED		DATE	06/15/11	DRAWING NO.
		5			TRACED		APPROVED		