

***HYDRUALIC MOTORS AVAILABLE:**

PART NUMBER	DISPLACEMENT	RATED PSI
4200SA - 16	.95 cu. in.	3,500
4200SA - 15	.88 cu. in.	3,500
4200SA/5000 - 16	.63 cu. in.	5,000
4200SA/5000 - 15	.59 cu. in.	5,000

INNERSPACE CORP.
 1138 E. EDNA PLACE
 COVINA, CA 91724
 TEL: (626) 331-0921
 FAX: (626) 966-6391
 www.innerspacethrusters.com

13 Spacers are not shown.
 If needed, the spacers will go
 between the hub & prop to
 achieve a prop tip clearance
 of .010" - .020"

ITEM #	QTY	PART NAME	PART NO.
17	1	HYDRAULIC MOTOR	4200SA*
16	2	TAB - MOTOR FAIRING	1002 - W
15	1	MOTOR FAIRING	1002 - V
14	1	DUCT	1002 - O
13	1	SPACER - .063" OR .125"	1002 - M
12	1	WASHER - PROP HUB	1002 - L
11	1	NUT - SHAFT	1002 - K
10	4	SHCS - MOTOR	1002 - I
9	1	KEY	1002 - H
8	1	HEX NUT - TIE ROD	1002 - G
7	1	NYLOX NUT - TIE ROD	1002 - J
6	1	SPINNER	1002 - F
5	1	TIE ROD	1002 - E
4	1	WASHER - SPINNER	1002 - D
3	4	SHCS - PROP HUB	1002 - Q
2	1	PROPELLER HUB	1002 - C
1	1	5 BLADE PROPELLER	1002 - A

PARTS LIST

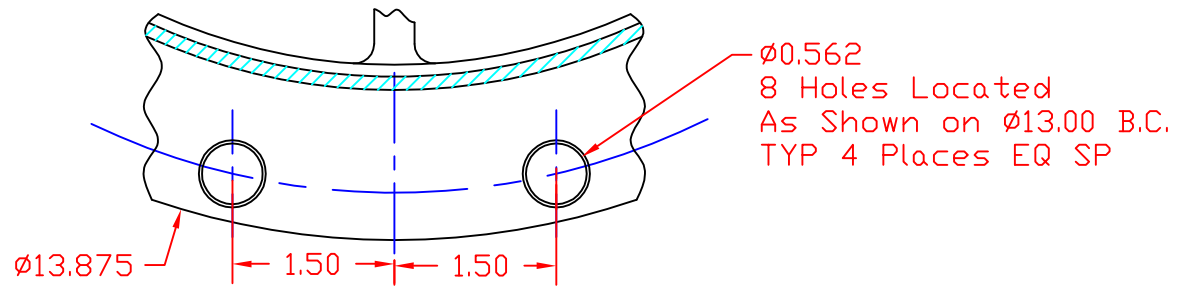

Section A - A

PROPRIETARY

TOLERANCES (EXCEPT AS NOTED)		REVISIONS			INNERSPACE CORP.		
NO.	DATE	BY	SCALE	DRAWN BY	DATE	DRAWING NO.	
.XXX							
± .005							
.XX							
± .01							
ANGULAR							
± 1/2°							

1002/4200SA HYDRAULIC THRUSTER ASSEMBLY

DRAWN BY OR DATE 12/1/04 MATERIAL 1002/4200SA - ASSY